



AIRCHARGER™ HIGH-FLOW INTAKE KITS

INSTALLATION INSTRUCTIONS

63-1122

HARLEY DAVIDSON

2008-09 Harley Davidson Touring Models:

FLHR, FLHRC, FLHT, FLHTC

FLHTCU, FLHX, FLTR

1584CC

TOOLS NEEDED:

- 3/16" allen wrench
- 5/16" allen wrench
- 7/16" socket
- 3/4" wrench
- extension
- flat blade screwdriver
- ratchet
- T27 torx socket

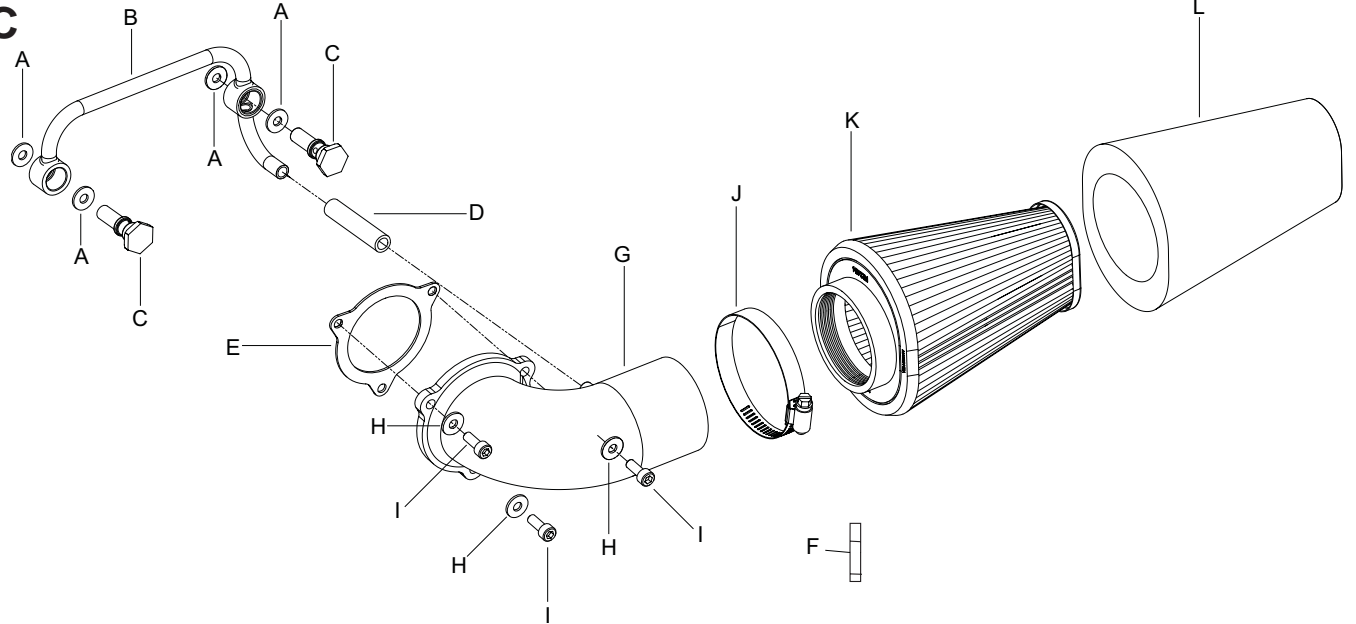

PARTS LIST:

Description	Qty.	Part #	Description	Qty.	Part #
A Washer; 1/2"ID, .040"THK	4	08322	G Intake Tube	1	27405
B Breather Tube; Chrome	1	21679	H Washer; 6mm Flat, SS	3	08269
C Bolt; Breather, Harley Davidson	2	22210	I Screw; 1/4-20 X 3/4 SOC. HD. CAP Screw, SS	3	07731
D Hose; 2-1/4" 8MM	1	08062	J Hose Clamp #40	1	08554
E Gasket; HD-1508	1	10489	K Air Filter	1	RC-3680
F Thread Locker	1	Roush-482	L Drycharger®	1	RC3680DK

NOTE: FAILURE TO FOLLOW INSTALLATION INSTRUCTIONS AND NOT USING THE PROVIDED HARDWARE MAY DAMAGE THE INTAKE TUBE, THROTTLE BODY AND ENGINE.

TO START:

1. Turn off the ignition and disconnect the negative-battery cable.



2. Remove the air filter cover bolt and air filter cover as shown.



3. Loosen the three air filter retaining bolts shown.



4. Remove the air filter from the vehicle and disconnect the crank case breather tubes.



5. Remove the two breather / air filter base mounting bolts shown.



6. Remove the air filter base from the vehicle as shown.



7. Install the supplied crank case breather tube using the provided breather bolts and washers.
NOTE: Place one washer on each side of the of the breather tube.



8. Trim the provided crank case breather hose to a length of 1.5" and then install it onto the K&N® intake tube as shown.



9. Install the K&N® intake tube onto the throttle body along with the provided gasket and secure with the provided mounting bolts.

NOTE: Apply a drop of the provided thread locker to the threads of the intake tube mounting bolts.



10. Install the provided K&N® air filter and secure with the provided hose clamp.

NOTE: The K&N® high flow intake system is a performance product that can be used safely during mild weather conditions. During harsh and inclement weather conditions, you must install the K&N® Drycharger® onto the air filter. Failure to follow these instructions can void your warranty.

NOTE: Please be aware the Drycharger® is water repellent, not water proof. Depending on conditions and usage the water repellent treatment is good for 1 to 2 years. See the parts list to reorder a new Drycharger® if necessary.

11. It will be necessary for all K&N® high flow intake systems to be checked periodically for realignment, clearance and tightening of all connections. Failure to follow the above instructions or proper maintenance may void warranty.

ROAD TESTING:

1. Start the engine with the transmission in neutral or park. Listen for air leaks or odd noises. For air leaks secure hoses and connections. For odd noises, find cause and repair before proceeding. This kit will function identically to the factory system except for being louder and much more responsive.

2. Test drive the vehicle. Listen for odd noises or rattles and fix as necessary.

3. If road test is fine, you can now enjoy the added power and performance from your kit.

4. K&N Engineering, Inc., suggests checking the air filter element periodically for excessive dirt build-up. When the element becomes covered in dirt (or once a year), service it according to the instructions on the Recharger® service kit, part number 99-5050 or 99-5000.