



# Installation Instructions Touring link™ 1993 - 2008 FLH/FLT

### ATTENTION

Statements in these instructions that are preceded by the following words are of special significance:

#### Warning

This means there is the possibility of injury to yourself or others.

#### Caution

This means there is the possibility of damage to the vehicle.

#### Note

*Information of particular importance has been placed in italics.*

### IMPORTANT NOTICE

**Caution:** Follow instructions in an authorized shop manual or take the vehicle to a competent dealer.

The vehicle must be securely blocked to prevent it from dropping or tipping when the swingarm mount is removed. Failure to do so can cause serious damage and/or injury.

Progressive Suspension Touring link™ is designed to work with the OEM (Original Equipment) frame. Use of this system on a frame other than OEM may produce an unsatisfactory ride and void the warranty.

*Be sure to refer to instruction supplements provided in any included mounting hardware*

### Warranty

Progressive Suspension Inc. warrants to the original purchaser this Part to be free of manufacturing defects in materials and workmanship for a period of one (1) year from the date of purchase. In the event warranty service is required, you must call Progressive Suspension immediately with a description of the problem.

If it is deemed necessary for Progressive Suspension to make an evaluation to determine whether the part is defective, a return authorization number will be given by Progressive Suspension. The parts must be packaged properly so as to not cause further damage and returned prepaid to Progressive Suspension with a copy of the original invoice of purchase and a detailed letter outlining the nature of the problem. If after the evaluation by Progressive Suspension the part was found to be defective it will be repaired or replaced at no cost to you. If we replace it, we may replace it with a reconditioned one of the same design.

Progressive Suspension shall not be held liable for any consequential or incidental damages resulting from the failure of a Progressive Suspension part. Progressive Suspension shall have no obligation if a part becomes defective as a result of improper installation or abuse.

#### Warning

Changing the chassis and/or suspension on any vehicle will change the handling characteristics of that vehicle. Care should be taken when operating the vehicle with such modifications while getting accustomed to the new handling characteristics.

## Installation

1. Using a suitable jack, lift the motorcycle up just high enough to unload the rear wheel but do not lift the rear wheel off the ground. Be sure place the jack in a location that will leave you access to the rear transmission pan bolts.
2. Loosen or remove right side exhaust components and any other accessories that would prohibit access and removal of the right "rear fork mount" or swingarm mount. (figure 1)

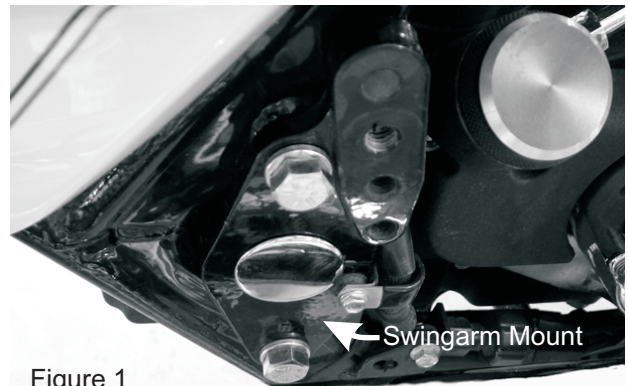
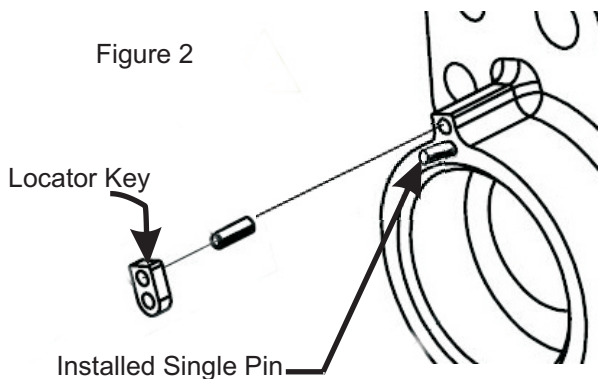

Figure 1

3. Remove the right passenger foot peg or floorboard from the aforementioned swingarm mount.
4. Per the authorized factory manual, remove the stock right swingarm mount noting orientation and hardware locations. Stock hardware will be reused. Be sure to carefully remove the chrome cap which will be re-used as well.

5. Before installing the Touring link™ frame mount (similar to the swingarm mount just removed), there may be a need to install the frame mount locator key (figure 2). If you are installing this kit on a 2003-2008 FLH/FLT then you need to press this component into the frame mount - flat edge up - as shown before installing the mount on the bike. The 1993-2002 FLH/FLT models will not require the installation of this locator key, as they only require the single installed pin in the lower hole as shown.



6. Orient the Touring link™ frame mount the same as the previously removed stock swingarm mount, and use the stock hardware to mount it. **NOTE:** When installing the Touring Link on Models fitted with Passenger Foot Pegs instead of Passenger Floorboards, replace the original split lock washer under the top chassis mount mounting bolt with the New Serrated Lock Washer supplied in the kit. This will provide proper Bolt Head clearance for reinstalling the passenger foot pegs (figure 3). Be sure to apply proper thread-locking agent to all bolts and torque to the values called out in a factory authorized repair manual.

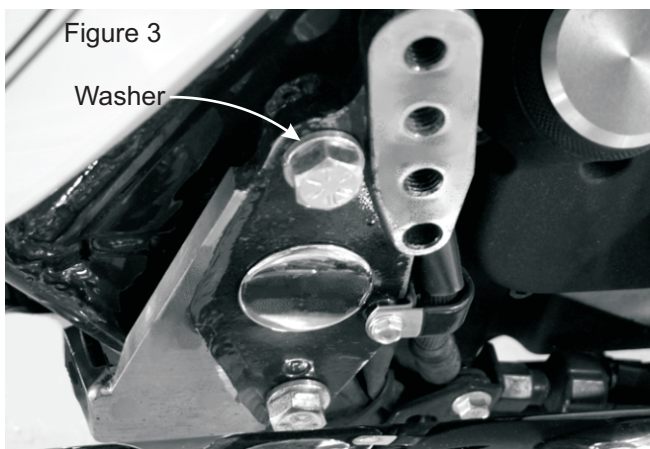

7. Locate and remove the right rear corner transmission pan bolt. Then remove the center rear bolt and the first bolt in front of the right rear corner bolt. These three bolt holes will be used for mounting the Touring link™ transmission mount

8. Install the Touring link™ transmission mount using the two supplied 1/4-20 X 1-3/4" SHCS on the rear two holes and the 1-3/8" long one in the front hole (figure 4). Torque to values noted in a authorized factory manual for the transmission pan bolts.

9. Verify vehicle alignment by following the procedure outlined in an authorized factory manual. Vehicle alignment is crucial to ensure proper handling and vibration control.

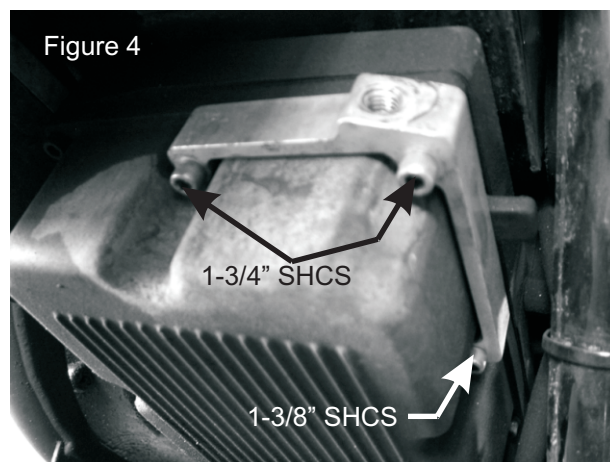

10. After verifying vehicle alignment, connect the two Touring link™ mounts with the connecting rod using the two 3/8-16 X 1" SHCS. Put the screws through the rod ends, then through the supplied 3/8" flat washers (1 per SHCS), apply two drops of thread-locking agent to each of the screws, then thread them into the mounts (figure 5). **NOTE: You must install the connecting rod as shown in Figure 5 to insure sufficient clearance and proper operation.** Torque both 3/8-16 X 1" SHCS to 24 ft/lbs.

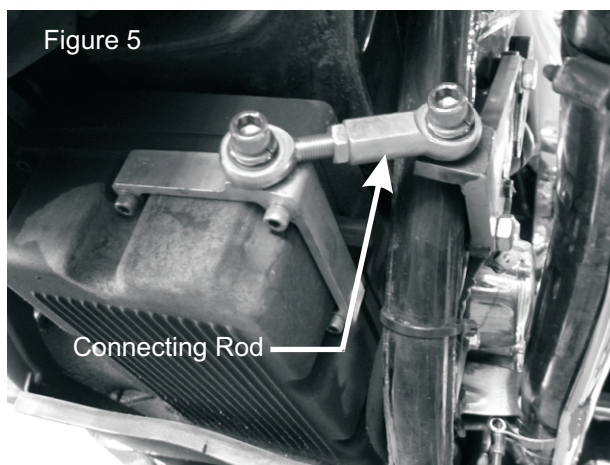

**NOTE:** The connecting rod length is preset and should not require adjustment, but if it does simply loosen the lock